



Ashtons

Wolsley Street, Off Heslington Road, York, YO10 5BQ



Wolsley Street  
Off Heslington Road, York  
YO10 5BQ

£284,000



A superb example of a period end terrace, this stylish and well-maintained two bedroom home is perfectly positioned for city living, just a short stroll from the city centre and within easy reach of York University.

The property opens into a charming front lounge featuring an original open cast fireplace with marble surround. To the rear, the home has been extended to create a bright and spacious open-plan kitchen/dining room, ideal for modern living. This space is flooded with natural light from a large rear window and Velux skylight and is fitted with a range of contemporary wall and base units, wood-effect worktops, tiled splashbacks and space for appliances including a cooker, fridge, washing machine and dishwasher. Recessed ceiling spotlights and a practical open staircase complete the space, while a rear lobby provides access to a ground floor WC and the west-facing rear yard.

Upstairs are two well-proportioned double bedrooms, with the front bedroom benefiting from a built-in cupboard. The bathroom is neatly finished with a three-piece suite including a bath with shower over, and a cupboard housing the gas combi boiler.

Additional features include double glazing, an Envirovent clean air filter system and a generous rear yard with side access, walled boundaries and a large storage shed.

This is an ideal home for professionals, first-time buyers or investors looking for a character property within walking distance of the city centre, York train station and the university. Early viewing is recommended.

Council Tax Band B









# Wolsley Street Off Heslington Road, YO10 5BQ

Freehold  
Council Tax Band - B

- Period End Terrace House
- Two Double Bedrooms
- Rear Kitchen Extension
- Large Rear Yard
- Sought After Location
- Well Presented
- EPC D

GROUND FLOOR  
426 sq.ft. (39.6 sq.m.) approx.

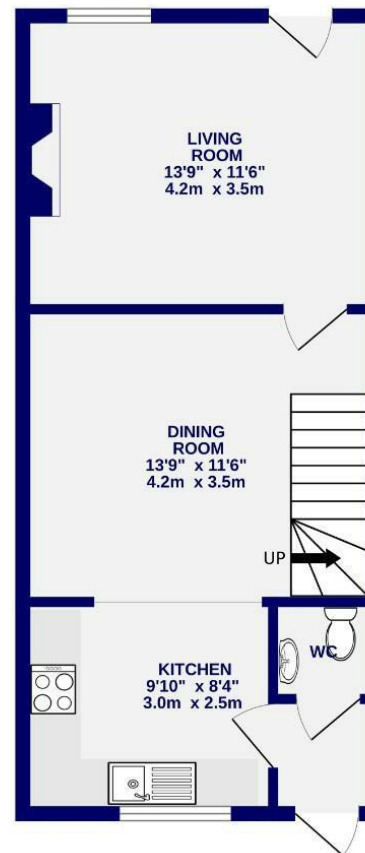

1ST FLOOR  
312 sq.ft. (28.9 sq.m.) approx.

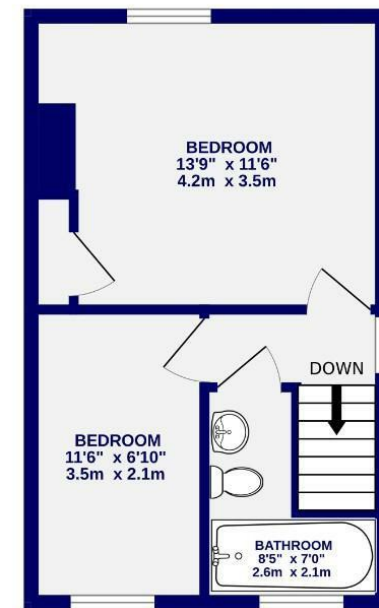

TOTAL FLOOR AREA: 738 sq.ft. (68.5 sq.m.) approx.  
Whilst every attempt has been made to ensure the accuracy of the floorplan, measurements of rooms and any other items are approximate. If included in the plan the garage/stores will form part of the overall floor area and no responsibility is taken for any error, omission or mis-statement. This plan is for illustrative purposes only and should be used as such by any prospective purchaser. The services, systems and appliances shown have not been tested and no guarantee as to their operability.  
Made with Metropix C0205

These particulars have been prepared as accurately and as reliably as possible, but should not be relied upon as 'statement of fact'. If there is any point which is of particular importance to you, please contact the office and we would be pleased to check the information. We have not tested any services, appliances, equipment or facilities and nothing in these particulars should be deemed to be a statement that they are in good working order, or that the property is in good structural condition or otherwise. Any areas, measurements, floor plans or distances referred to are given as a guide only and are not precise. Purchasers must satisfy themselves by inspection or by otherwise regarding the items mentioned above and as to the correctness of each of the statements contained in these particulars. No person in the employment of Ashtons has any authority to make or give any representation or warranty whatsoever in relation to this property or these particulars nor enter into any contract relating to the property on behalf of the vendor.